

INSTALL GUIDE

MFES-JK SKID PLATE

MFES-JK EQUIPPED
JEEP WRANGLER / UNLIMITED
2007-2013



Table of Contents / MFES-JK Skid Plate Install Guide

Table of Contents

Parts List	1
Overview and Required Tools	2
Skid Plate Assembly	3
Final Check	7

Thank you for purchasing your new Pronghorn Overland Gear MFES-JK Skid Plate! This install guide will assist you in the complete process of installing your new system. Please read through these instructions entirely before you begin the installation process. This will familiarize you with the process and alert you to any unique tools or materials that may be required for successful installation. If you have questions regarding any step of the installation process please do not hesitate to contact us at +1 803 249 5555.

This system is designed to be a fully bolt-in installation with no cutting or drilling required. Installation is not overly complex, however, it is important to honestly evaluate your mechanical skills and determine if you are capable of performing the installation or if you should have the system installed by a professional mechanic.

Pronghorn Overland Gear Product Development Team



Parts List

<i>Part</i>	<i>Quantity</i>	<i>Part Number</i>
Skid Plate	1	MFES-JK-0610
Bash Plate	1	MFES-JK-0620
Skid Plate Spacer	4	MFES-JK-0630
M10-1.5 x 30 Bolt	11	
M10-1.5 x 50 Bolt	4	
M10-1.5 Locknut	15	
M10 Washer	30	
M14 Washer	4	

Overview

Clean Vehicle

As with any vehicle modification project, the process will be easier, faster and safer if the vehicle is thoroughly cleaned before you begin the project.

Disconnect Battery

Before beginning any work on this installation disconnect the negative terminal of the battery.

Fasteners

All fasteners must be properly installed and tightened to ensure safety and proper performance. Recovery devices will be attached to this system and for proper and safe requirement it is critical that all fasteners be installed and tightened properly. A general knowledge of how to use and install fasteners is assumed and if you have questions on the proper use of fasteners please contact us.

IMPORTANT INFORMATION

THIS SKID PLATE IS DESIGNED AS A HIGH-STRENGTH, HIGH-PERFORMANCE ADDITION TO YOUR JEEP WRANGLER MFES-JK. IT HAS BEEN ENGINEERED TO WORK WITH THE EXISTING FACTORY SYSTEMS AND IMPROVE THE OVERALL VEHICLE PERFORMANCE IN SEVERE OFF-ROAD AND EXPEDITION APPLICATIONS. PROPER INSTALLATION IS CRITICAL TO ENSURE THAT THE SYSTEM PERFORMS AS ENGINEERED. MODIFICATION OR OMISSION OF COMPONENTS WILL VOID THE LIFETIME WARRANTY OF THE SYSTEM AND CAN GREATLY REDUCE THE PERFORMANCE AND SAFETY OF THIS SYSTEM DURING USE. IF YOU SHOULD HAVE DIFFICULTIES OR ISSUES WITH THE INSTALLATION OF THE SYSTEM OR FIND ANY PARTS TO BE DAMAGED OF MISSING PLEASE CONTACT US FOR ASSISTANCE AND REPLACEMENT PARTS.

Required Tools and Materials

The MFES-JK is a No Cut / No Drill installation. To efficiently complete the installation of your intercooler you will need the following tools and materials, in addition to those parts supplied with your MFES-JK Skid Plate.

Tools

- 17mm Socket (and suitable ratchet)
- 17mm Wrench (box/open)

Materials

- Touch-Up Paint (for vehicle frame if required)

Parts List

MFES-JK Skid Plate	x 2
MFES-JK Bash Plate	x 8
M10-1.5 x 30 Bolt	x 5
M10-1.5 Locknut	x 5
M10 Washers	x 10

M10-1.5 Locknut

M10 Washer

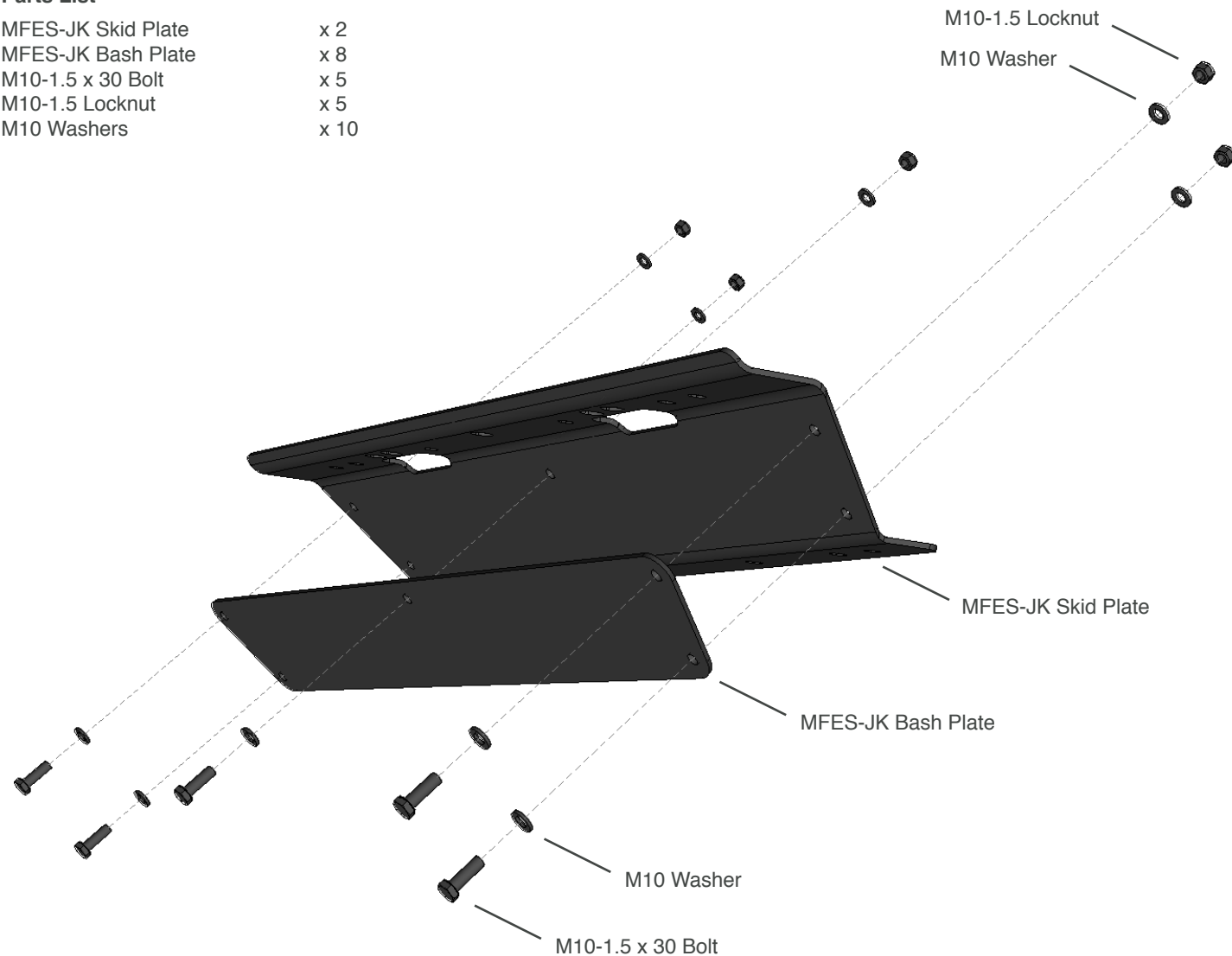

Assembly Notes

- 1) Using M10-1.5 x 30 bolts, locknuts, and washers attach the MFES-JK Bash Plate to the MFES-JK Skid Plate as shown above.
- 2) Tighten fasteners.

Mounting Skid Plate / MFES-JK Skid Plate Install Guide

Assembly Notes

- 1) Locate six (6) Skid Plate mounting holes on lower front of the MFES-JK Center Section (as shown).

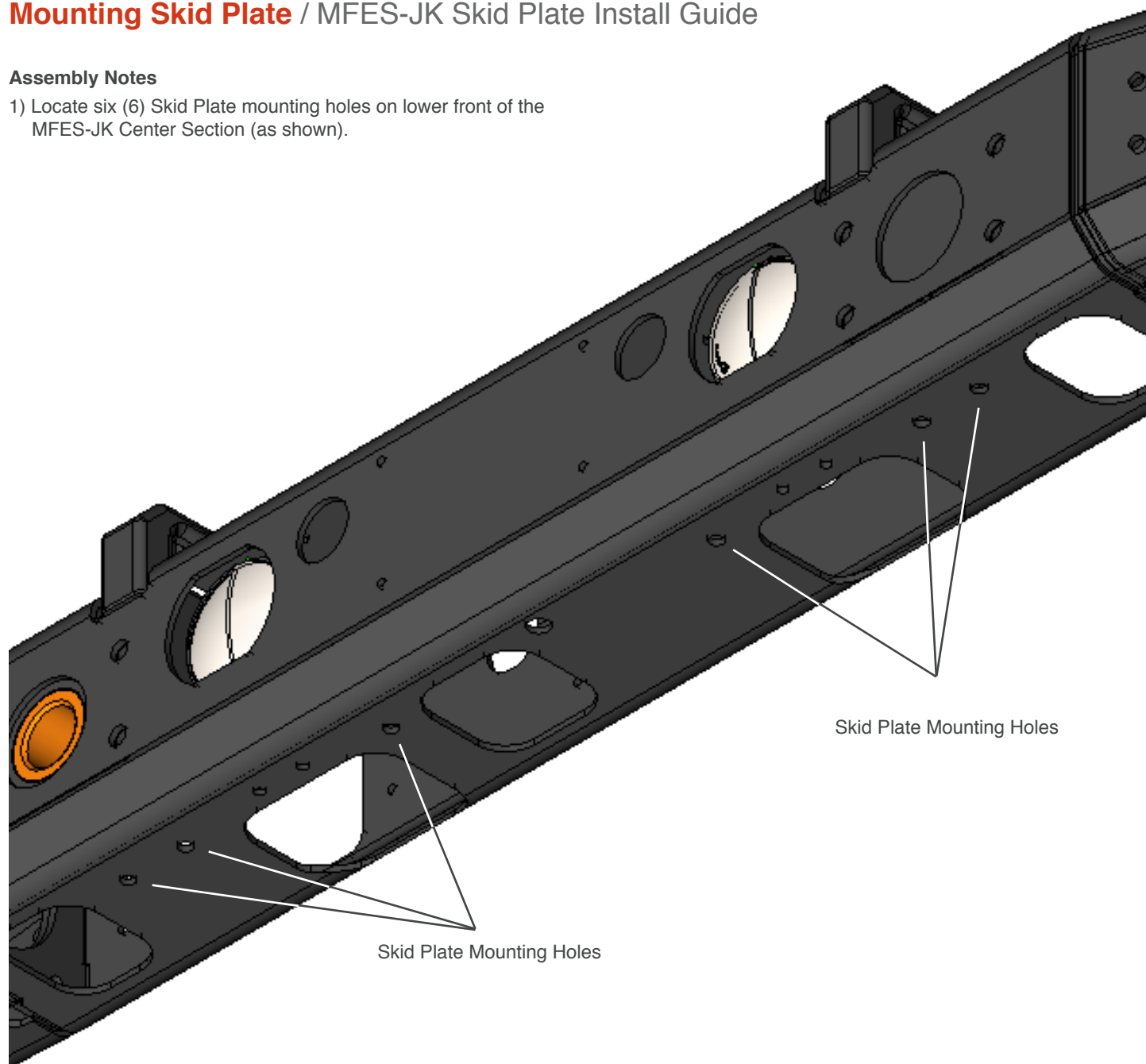

Parts List

MFES-JK Skid Plate Assembly	x 1
MFES-JK Bash Plate	x 8
M10-1.5 x 30 Bolt	x 6
M10-1.5 Locknut	x 6
M10 Washers	x 12

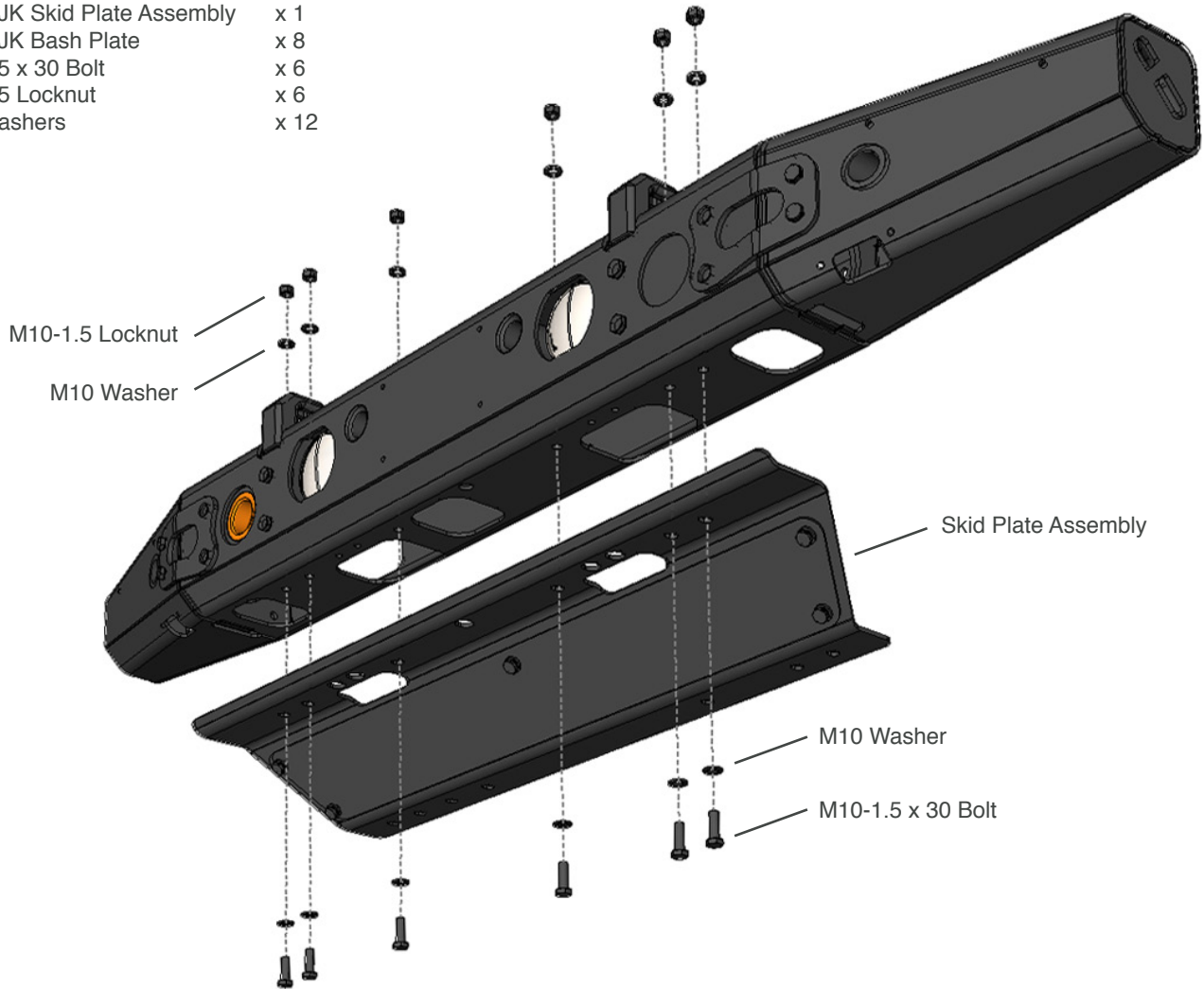

Assembly Notes

- 1) Position Skid Plate Assembly under MFES-JK Center Section.
- 2) Install, but do not tighten, middle two (2) M10 bolt/washer/nut assemblies as shown.
- 3) Install, but do not tighten, remaining four (4) M10 bolt/washer/nut assemblies as shown.

Parts List

MFES-JK Skid Plate Assembly	x 1
Skid Plate Spacer	x 4
M10-1.5 x 50 Bolt	x 4
M10-1.5 Locknut	x 6
M10 Washers	x 8
M14 Washers	x 4

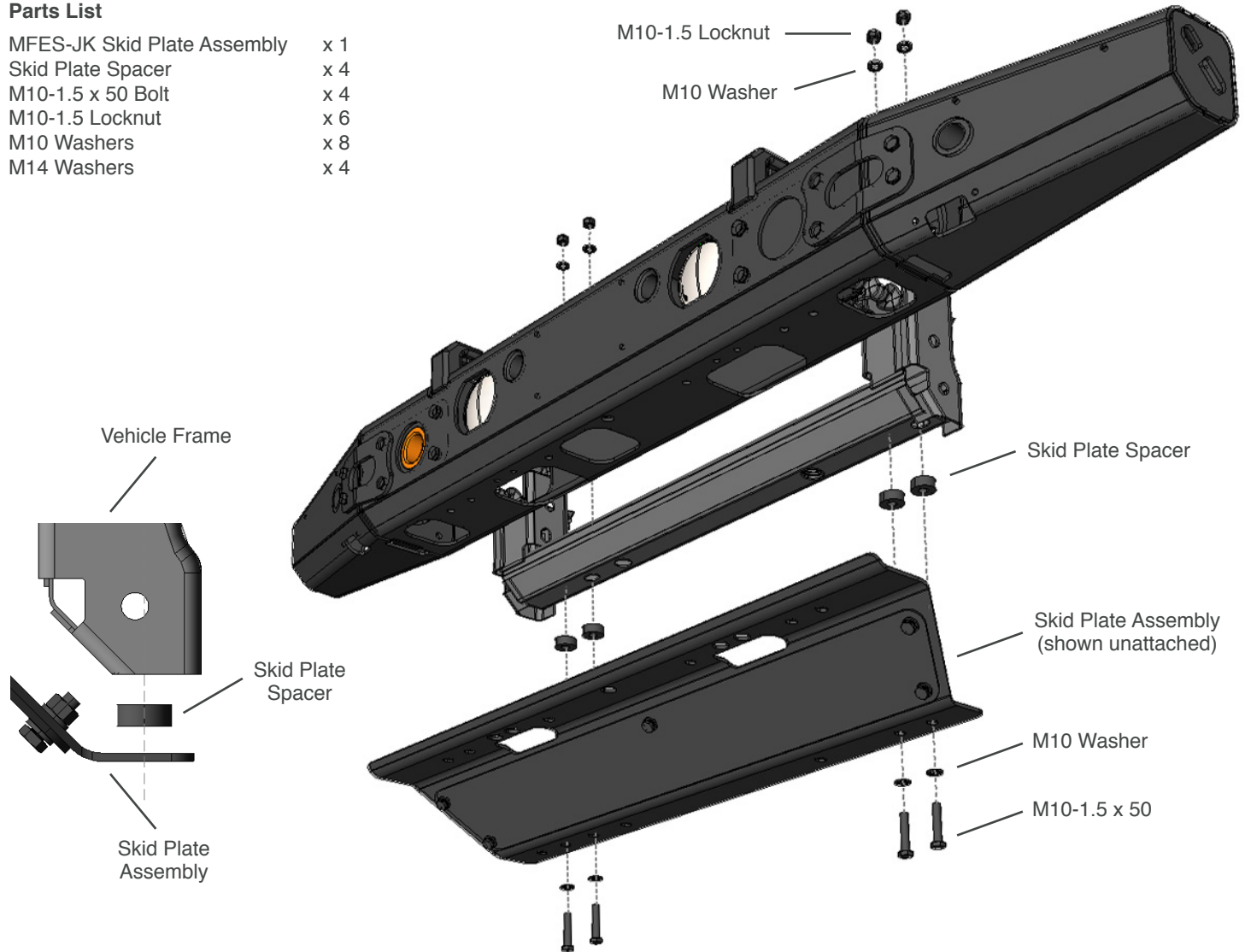

Assembly Notes

- 1) Position four (4) Skid Plate Spacers between the Skid Plate Assembly and the Lower Cross Guard. Use the two outermost available holes on each side of the Lower Cross Guard.
- 2) Install four (4) M10 bolt/washer/nut assemblies into mounting holes used for the Spacers.
- 3) Tighten all fasteners assemblies.

Before driving the vehicle recheck all fasteners to ensure they are properly secured and all parts are correctly installed. We recommend rechecking all fasteners and system components after 250 miles of driving to ensure they are properly tightened and secure.

Apply Logo Decal (Optional)

A decal is included with your MFES-JK Skid Plate. To install decal

Care of Powder Coating

Your MFES-JK Skid Plate is constructed from 6061-T6 aluminum and will provide many years of trouble service in all conditions. The system is designed to withstand conditions that will cause corrosion in steel bumpers with issue. However, the powder coating applied to the MFES-JK Skid Plate is not bullet proof and aggressive off-road use will result in damage to the powder coating. The aluminum structure of the MFES-JK SKid Plate will not suffer from these scratches though we recommend touching up the damage as this will help prevent further chipping of the powder coating.

Care of the Fasteners

The fasteners used with the MFES-JK are coated with a three-stage finish and are designed to withstand high corrosion environments (1000+ hours salt spray test). This coating can be damaged or degraded by heavy contact with rocks or hard debris, as is the case with standard zinc coated fasteners. If the coating on your fasteners should become damaged or scratched and rust forms we offer replacement fasteners through our website or call us directly at +1 830 249 5555. Scratches and damage should be touched up to prevent rust from forming on the fasteners.